



Grade 80 Toebehoren volgens EN 1677 / Grade 80 Accessories according to EN 1677

7. Ooghaken met klep /
Eye hooks with latch



8. Wartel haken met klep /
Swivel hooks with latch
(Onbelast wartelen / Swivel without load)



9. Wartel haken met klep
en lager /
Swivel hooks with latch
and bearing
(Belast wartelen / Swivel with load)



YE.8.044

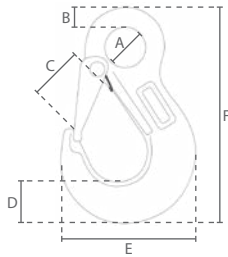

YE.8.087

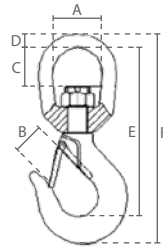

YE.8.088

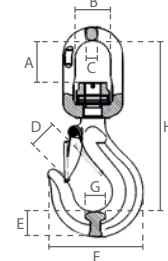

| 7 Specificaties / Specifications | | | Afmetingen / Dimensions (mm) | | | | | | |
|----------------------------------|-----------------------|------------------|------------------------------|----|----|----|-----|-----|--|
| Artikel nummer | Capaciteit / Capacity | Gewicht / Weight | A | B | C | D | E | F | |
| Article code | ton | kg | | | | | | | |
| YE.8.044.06 | 1.12 | 0.3 | 21 | 9 | 19 | 20 | 68 | 109 | |
| YE.8.044.08 | 2.00 | 0.6 | 25 | 11 | 22 | 27 | 84 | 134 | |
| YE.8.044.10 | 3.15 | 1.1 | 34 | 14 | 28 | 33 | 103 | 168 | |
| YE.8.044.13 | 5.30 | 1.8 | 43 | 18 | 35 | 40 | 129 | 208 | |
| YE.8.044.16 | 8.00 | 3.2 | 52 | 22 | 43 | 48 | 157 | 253 | |
| YE.8.044.20 | 12.50 | 5.3 | 62 | 26 | 52 | 56 | 187 | 300 | |

| 8 Specificaties / Specifications | | | Afmetingen / Dimensions (mm) | | | | | | |
|----------------------------------|-----------------------|------------------|------------------------------|-----|-----|----|-----|-----|--|
| Artikel nummer | Capaciteit / Capacity | Gewicht / Weight | A | B | C | D | E | F | |
| Article code | ton | kg | | | | | | | |
| YE.8.087.06 | 1.12 | 0.4 | 32 | 22 | 17 | 9 | 109 | 137 | |
| YE.8.087.08 | 2.00 | 1.1 | 42 | 22 | 35 | 16 | 150 | 192 | |
| YE.8.087.10 | 3.15 | 1.3 | 43 | 26 | 35 | 16 | 163 | 209 | |
| YE.8.087.13 | 5.30 | 3.6 | 48 | 33 | 39 | 18 | 191 | 246 | |
| YE.8.087.16 | 8.00 | 4.7 | 62 | 43 | 53 | 25 | 244 | 313 | |
| YE.8.087.20 | 12.50 | 7.4 | 68 | 50 | 51 | 29 | 277 | 364 | |
| YE.8.087.22 | 15.00 | 10.6 | 79 | 55 | 65 | 32 | 332 | 431 | |
| YE.8.087.26 | 21.20 | 21.4 | 105 | 81 | 114 | 40 | 430 | 546 | |
| YE.8.087.32 | 31.50 | 32.0 | 105 | 100 | 100 | 40 | 466 | 596 | |

| 9 Specificaties / Specifications | | | Afmetingen / Dimensions (mm) | | | | | | | |
|----------------------------------|-----------------------|------------------|------------------------------|----|----|----|----|-----|----|-----|
| Artikel nummer | Capaciteit / Capacity | Gewicht / Weight | A | B | C | D | E | F | G | H |
| Article code | ton | kg | | | | | | | | |
| YE.8.088.06 | 1.12 | 0.7 | 30 | 33 | 11 | 25 | 20 | 69 | 16 | 136 |
| YE.8.088.08 | 2.00 | 1.0 | 42 | 36 | 13 | 29 | 23 | 88 | 20 | 170 |
| YE.8.088.10 | 3.15 | 1.7 | 50 | 42 | 16 | 31 | 30 | 105 | 23 | 205 |
| YE.8.088.13 | 5.30 | 3.0 | 58 | 50 | 17 | 44 | 38 | 135 | 32 | 242 |
| YE.8.088.16 | 8.00 | 5.3 | 64 | 61 | 22 | 45 | 46 | 161 | 38 | 292 |
| YE.8.088.20 | 12.50 | 9.5 | 86 | 74 | 25 | 56 | 50 | 192 | 49 | 356 |